

# APX 3 FOT

## Quick Installation Guide

These instructions are for the quick installation of the **APX 3 FOT**. For more detailed information please read the SRX manual.

### Assembly:

The **APX 3 FOT** is not fully assembled when delivered. This is to reduce volume of package and cost of transportation. To perform final assembly you have to use a screwdriver for recessed head

The **APX 3 FOT** consist of 3 parts: the left side, the right side and in the middle.

1

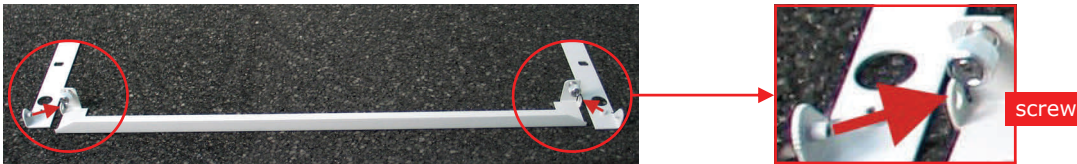

2



3

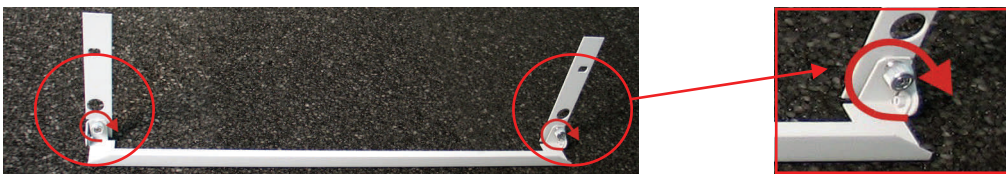

### Mounting:

1. You just need to remove the two top screws of the SRX sub-rack (left and right), not the bottom screws. This can be done without dismantling or moving the sub-rack; it will remain fixed to the cabinet rails. After removing the 2 top screws, place the **APX 3 FOT** in front of the sub-rack and install the 2 screws again. Now you can place and fix the FO-cables as desired.

1

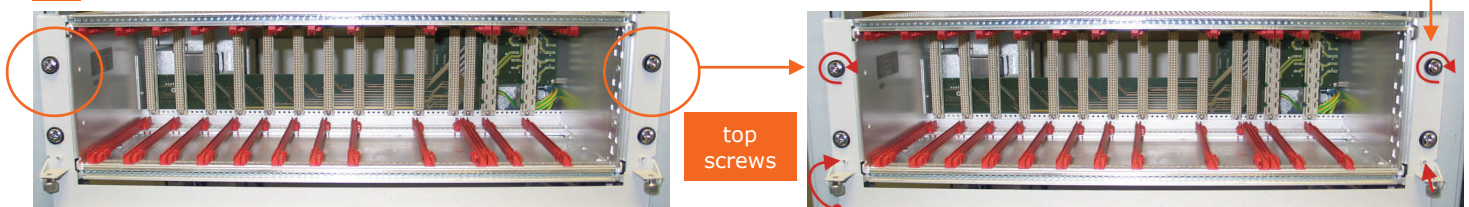

2. To plug in or remove the line-cards in the sub-rack, you can swing the tray down and up. To do this just loosen and tighten the two knurled screws as required.

2

